

# Powertrain Solutions Bearings

NBC provides solutions for manual, automated manual, automatic transmission, dual clutch transmissions and continuously variable transmissions. This includes powertrains with internal combustion engines and electric or electric hybrid.

## Features

- ✓ Reduced frictional losses
- ✓ Modified internal geometries to suit specific application requirements
- ✓ “ML” series bearings provides higher resistance to fatigue and higher performance
- ✓ Custom solutions, NBC strives to support customer by developing custom Next Gen solutions
- ✓ Ball bearings with special seals

## Benefits

- ✓ Improved driveline efficiency
- ✓ Increased performance
- ✓ Increased robustness
- ✓ Compact system

## Application

- ✓ Transmission
- ✓ Power take-off units
- ✓ Differential units

Follow us on:



## Pinion Bearing Solution:

With paired bearing combination and Next Gen solution, NBC offers ready-to-mount solutions to the customer. These solutions are customised for specific customer requirements, ensuring error-free fitment practice and optimum life of the system.

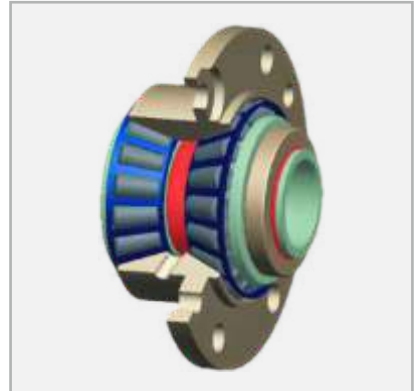
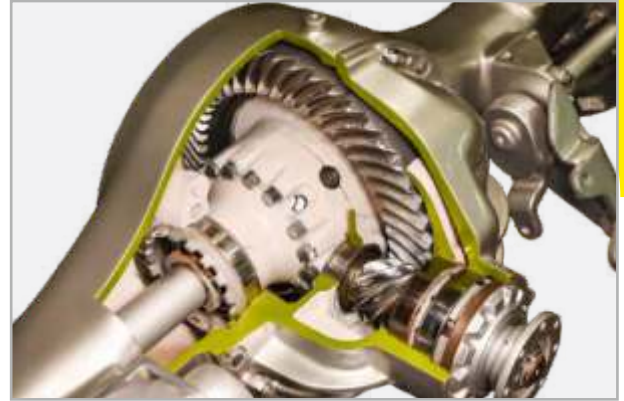

### Existing Arrangement

- ✓ Manual setting of pre-load
- ✓ In case set pre-load not met, re-setting
- ✓ Risk of excessive pre-load
- ✓ No control over higher pre-load

### Paired Bearing Configuration

- ✓ Pre-set pre-load through matched spacer on cup & cone
- ✓ Ready-to-mount bearing assembly
- ✓ Increased productivity – eliminates resetting

### Next Gen Solution

- ✓ Pre-set pre-load through integrated housing
- ✓ Ready-to-mount bearing assembly
- ✓ Increased productivity – eliminates resetting
- ✓ Improved stiffness of the system